

56 Forest Ridge, Waterdown

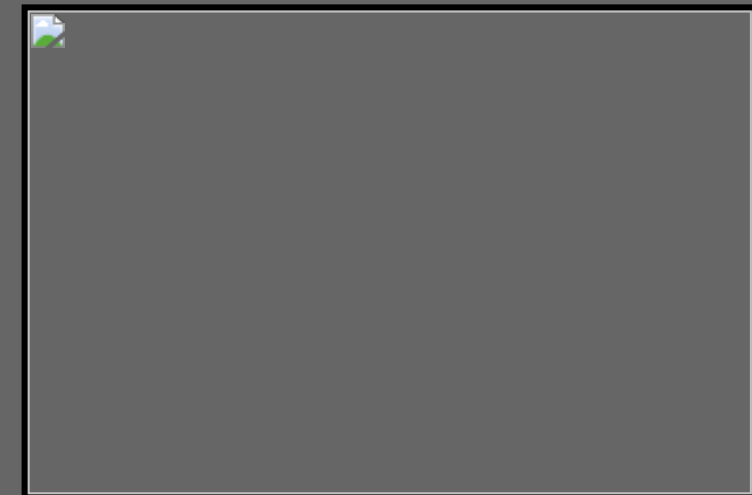

Allyson Slater
Broker Of Record
905.639.3355 |

Coldwell Banker Burnhill Realty Brokerage
431 Concession Street | Hamilton

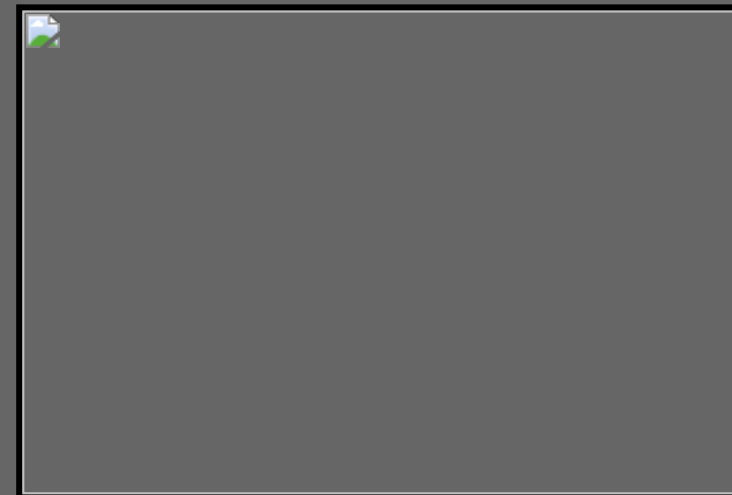
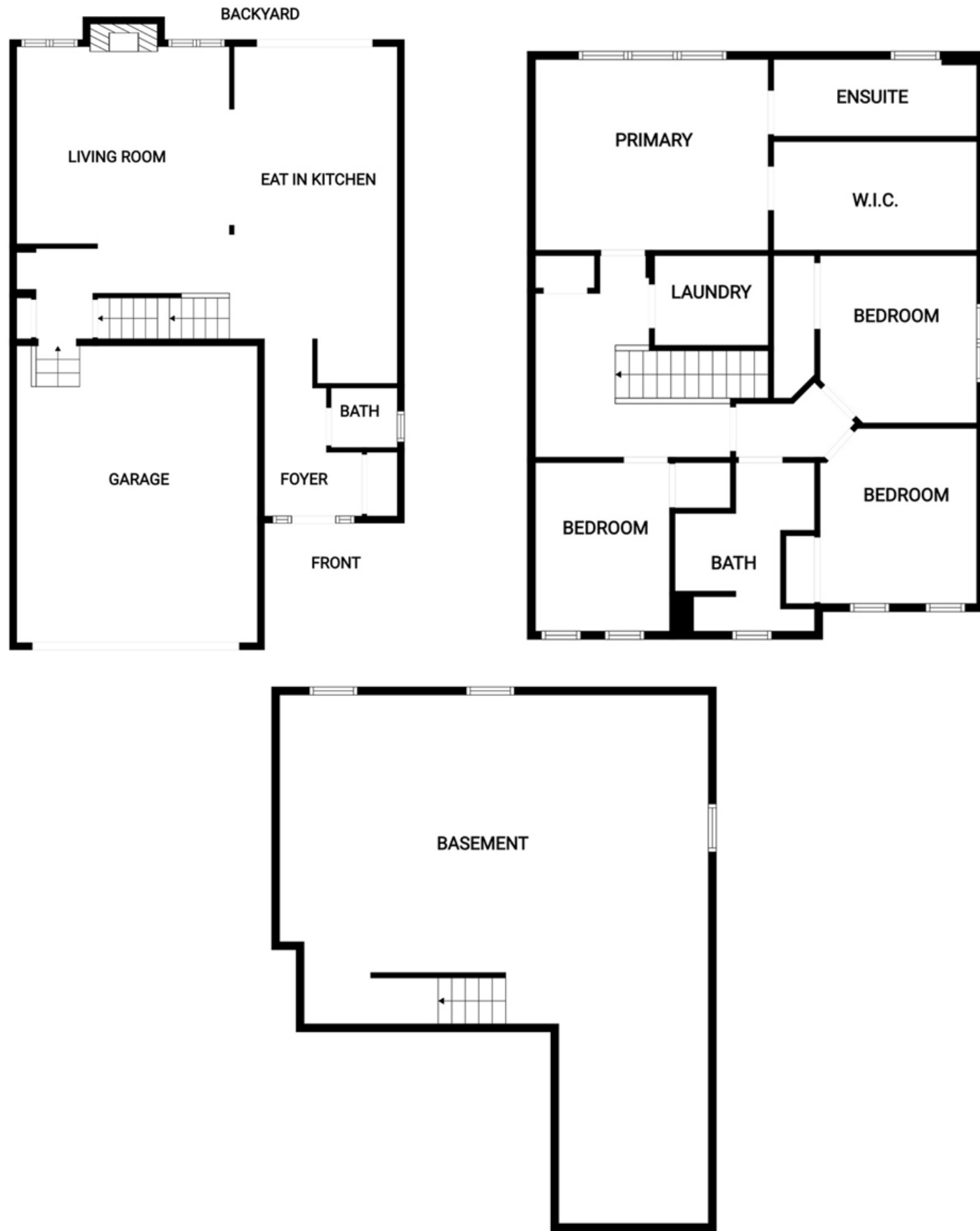

56 Forest Ridge, Waterdown



Above Grade Square Footage: 1985 sqft
(184.41m²)

Below Grade Finished Space: 835 sqft (77.57m²)

Main Level

Living Room 15'7" x 14'6" (4.75m x 4.42m)
Eat In Kitchen 21'5" x 12'3" (6.53m x 3.73m)
Foyer 13' x 7'8" (3.96m x 2.34m)
Entrance 15' x 6'10" (4.57m x 2.08m)
Powder Room 2P 5' x 4'6" (1.52m x 1.37m)
Garage* 19'9" x 17'4" (6.02m x 5.28m)

Upper Level

Primary 16'6" x 12' (5.03m x 3.66m)
WIC 11' x 6'4" (3.35m x 1.93m)
Ensuite 4P 11' x 5'4" (3.35m x 1.63m)
Bedroom 11'5" x 10'2" (3.48m x 3.10m)
Bedroom 11'5" x 10'2" (3.48m x 3.10m)
Bedroom 10'5" x 9'5" (3.18m x 2.87m)
Bathroom 4P 11'10" x 5'6" (3.61m x 1.68m)
Laundry 6'3" x 5'4" (1.91m x 1.63m)
Landing 12' x 6'10" (3.66m x 2.08m)

Lower Level

Utility 13' x 10' (3.96m x 3.05m)
Basement 21'4" x 27'7" (6.50m x 8.41m)

